

## Reverse Aid Camera

### Owner's Manual

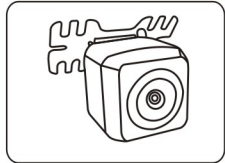

Model:CM1-T150B-PR

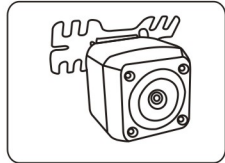

Model:CM3-T150B-PRI

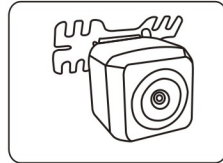

Model:CM2-T150B-PR HD

#### Specifications

Model	CM1-T150B-PR	CM3-T150B-PRI	CM2-T150B-PR HD
Current Consumption	MAX:80mA		
Power Supply	DC 9-16V		
Sensor IC	CMOS-III,1/4	CMOS-III,1/4	HD CMOS Sensor
Effective Pixels	648x488		
TV System	NTSC		
Video output	Color video out: 1.0Vp-p 75(ohm) load		
Resolution	420 TV Lines		
Angle	150		
Minimum illumination	0.2 Lux	0 Lux/3M,4 LEDs	0.1 Lux
Image	Mirror/Positive(Selectable)		
IR light	No	Yes	No
Parking Guide Line	On/Off(Selectable)		
Water Proof	Yes (IP67-IP68)		
Operating Temperature	-30°C to +70°C		

#### Product Features:

1. High resolution, low illumination and night vision.
2. 150° viewing angle(vertical 105°, horizontal120°).
3. Image correction function.
4. Water resistant.

#### Precautions:

- ▶ Remove protective lens covering prior to use.
- ▶ Be cautious when mounting camera and or wiring near fuel tank.
- ▶ System is designed for +12 volt DC systems only.

#### Electrical Connection:

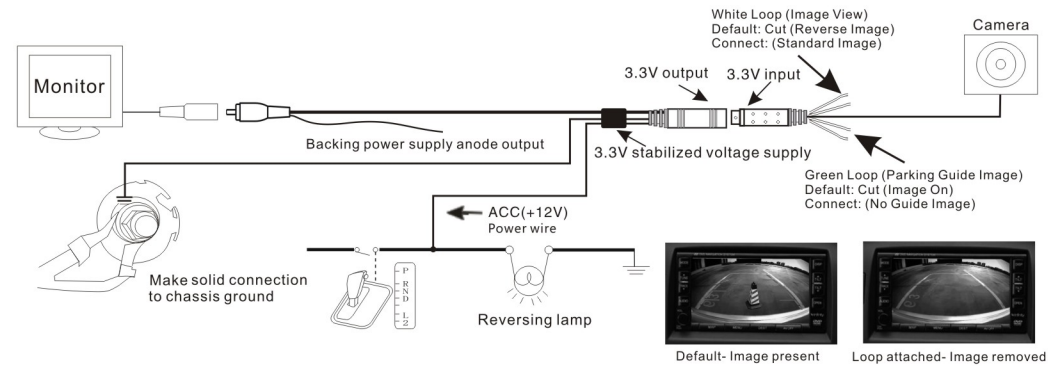

#### ● Camera Installation Position Options:

The camera can be positioned either on the bottom side of the trunk lid or on the face side of the rear trunk lid. Camera can be mounted using either double sided adhesive tape or by drilling into deck lid with short sheet metal screws. See Figures (1) and (2). Note: Disassembly of the camera mounting bracket may be necessary depending on mounting

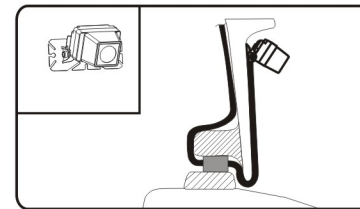

Image(1)

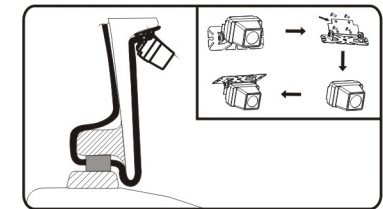

Image(2)

#### ● Angle Adjustment:

Once camera has been mounted you will need to adjust camera for best results. Secure parking brake, shift vehicle into reverse and adjust camera as noted in figures (3) and (4). Once desired angle is set tighten bolt on camera.

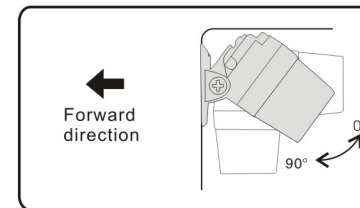

Image(3)

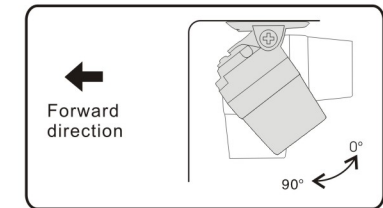

Image(4)