

(5) Connect the camera tail and the extension cable inside the car (Illustration 5).

Note: Jumper wires:

Green loop connected: Parking line off (Default).

Green loop disconnected: Parking line on.

White loop connected: For rear installation (Default).

White loop disconnected: For front installation.

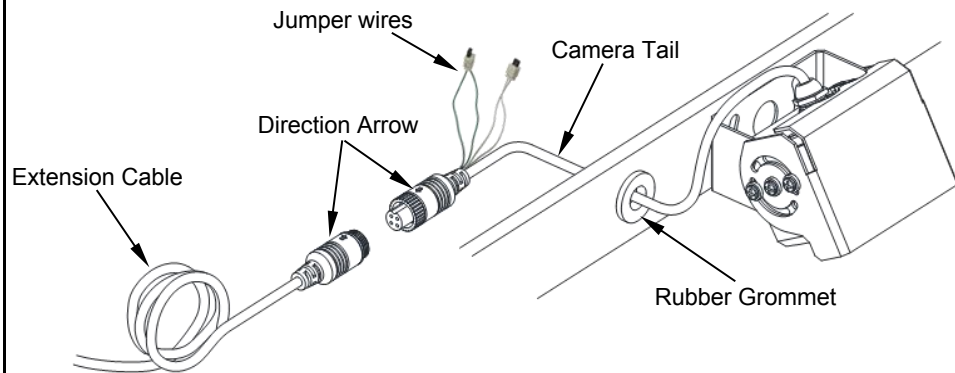

(Illustration 5)

(6) Loosen the screw between the camera and the fixed U-bracket and adjust the camera to a best viewing angle (Illustration 6).

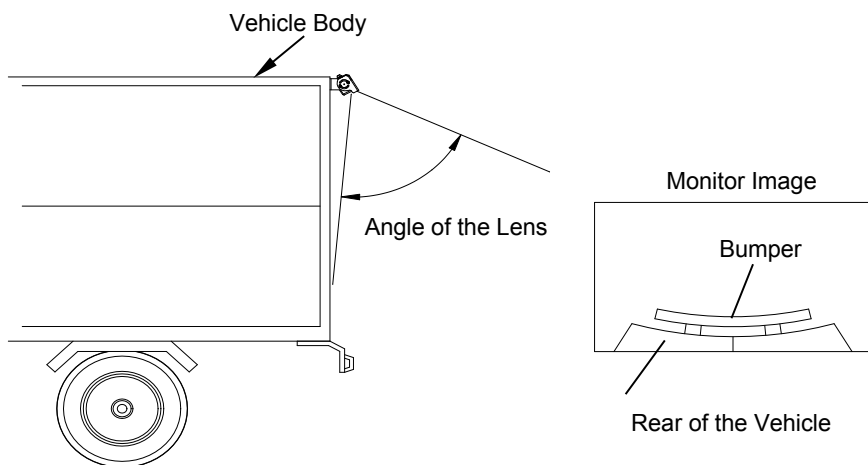

(Illustration 6)

RYDEEN[®]
find your road

Owner's Manual



Truck camera

Model: CM-R1000P/W

BLACK WHITE

Specifications:

Image Device:	1/3" Color CMOS
TV System:	NTSC
Effective Pixels:	976*592
Waterproof:	IP68
Sync. System:	Yes
Resolution:	630 TV Lines
Minimum Illumination:	0.1 Lux (day), 0 Lux (with IR)
Microphone:	Built in microphone
Lens Angle:	120°
Video Output:	1.0 vp-p, 75 Ohm
IR Light:	18 lights
AGC:	Auto
S/N Ratio:	+48 dB
White Balance:	Auto
Electronic Shutter:	Auto
BLC:	Auto
Current Consumption:	Day: 50 mA, Night: 180mA
Power Supply:	DC 12V/24V
Operating Temperature:	-40-+85°C (-40°F ~ 185°F)
Lens:	f=2.5mm, F=2.0
Backlight Compensation:	Yes
Parking line:	Parking line ON/OFF Selectable (Default: parking line off)
Image:	Mirror/ Standard Image Selectable (Default: mirror image)

Product features:

1. Waterproof: IP68 approved
2. Nightvision distance: approx. 3~100m (18 IR lights)
3. Day / Night sensor for automatic adjustment
4. Wider viewing angle up to 120 degrees

Precautions:

1. Be cautious when mounting camera and wiring near fuel tank.
2. The device is designed to work with +12 / +24 volt DC power supply.

Assembly:

■ CAMERA

①

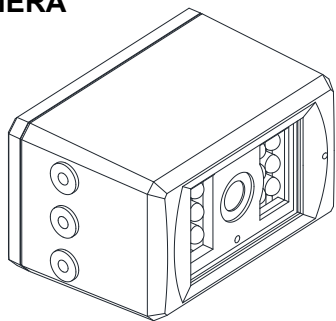

②

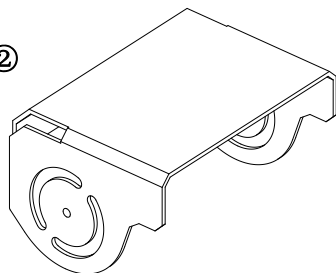

③

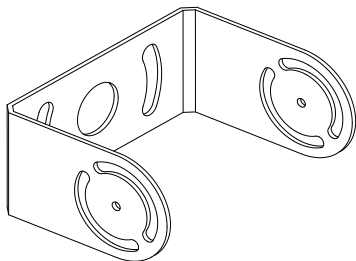

④

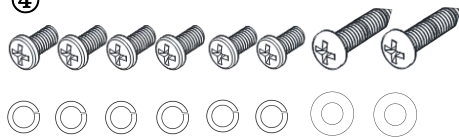

- | | |
|---|------|
| ① Camera (und detachable) | *1pc |
| ② Sunshield for camera | *1pc |
| ③ U-bracket for camera | *1pc |
| ④ Assembly parts for U-bracket | |
| ● Washer (stainless steel)*6pcs and Spacer (stainless steel)*2pcs | |
| ● PM2.5*8 screw(stainless steel)*6pcs and PA3*16 (stainless steel)*2pcs | |

Installation:

- (1) Find an appropriate location for installation (Illustration 1).
- (2) Drill holes according to the size of U-bracket as illustration 3 and fix the U-bracket by PA3*16 of screws and spacer as illustration 2.

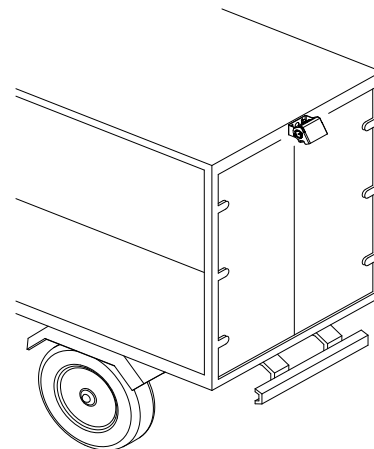

(Illustration 1)

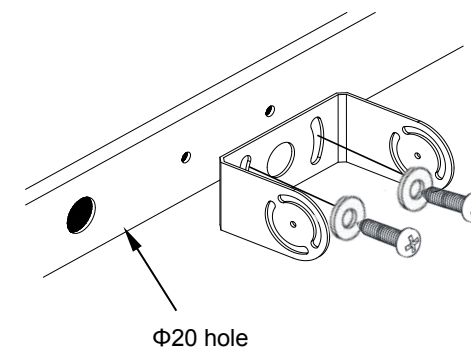

(Illustration 2)

- (3) Drill a Φ20mm hole next to the U-bracket (Illustration 2).
- (4) Fix the camera to the U-bracket (illustration 4).

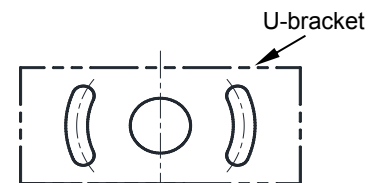

(Illustration 3)

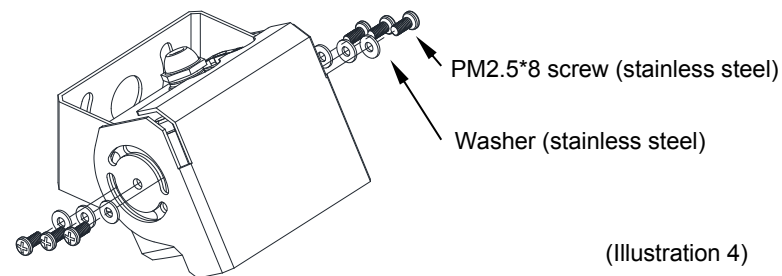

(Illustration 4)